

 **BACK FLOW PREVENTER zBAC**



Body material	Nominal pressure	Nominal diameter	Max. temperature
<b>A</b> Grey cast iron	<b>B</b> 10 bar	DN <b>65-150</b>	65°C

**FEATURES**

- compact mono block construction
- epoxy coating inside and outside
- silicon seal
- reduced pressure principle prevents potentially contaminated fluid polluting in the supply system
- easy to install and to maintain

**APPLICATION**

media



DRINKING  
WATER

Data given can be changed without notice.

Edition 01/2018

FIG.405

MATERIALS, DIMENSIONS

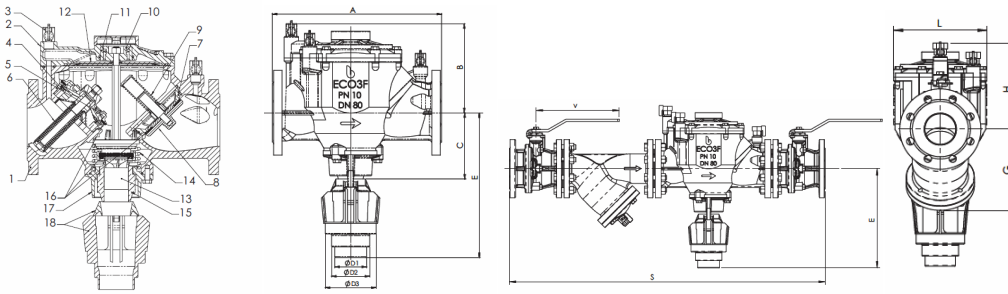

	Body material Type	A		
		34 – DN 65	34 – DN 80-100	34 – DN 150
1	Body	EN-GJL-250 5.1301 (ex. JL1040)		
2	Cover	EN-GJL-250 5.1301 (ex. JL1040)		
3	Valve 1/2" F	DRL brass		
4	Upstream valve seat	NORYL (PPO)	G-CuSn5Zn5Pb5	
5	Upstream valve shutter	NORYL (PPO)	G-CuSn5Zn5Pb5	
6	Upstream valve spring	AISI 302		
7	Downstream valve seat	NORYL (PPO)	G-CuSn5Zn5Pb5	
8	Downstream valve shutter	DRL brass	G-CuSn5Zn5Pb5	
9	Downstream valve spring	AISI 302		
10	Compensator	DRL brass		
11	Compensator liner	PTFE+C		
12	Membrane	Neoprene + Nylon		
13	Relief valve obturator	DRL brass	AISI 304	
14	Relief valve spring	AISI 302		
15	Relief valve seat	DRL brass	AISI 304	
16	Seal gasket	Silicone rubber		
17	Behind cover	EN-GJL-250 5.1301 (ex. JL1040)		
18	Conveyer	Polypropylene		
<b>Max. temperature</b>		<b>65°C</b>		

DN		65	80	100	150
A (mm)		360	400	450	540
B (mm)		200	214	234	259
C (mm)		137,5	157	163	185
D 1/2/3 (mm)		75/90/120			
E (mm)		290	342	350	370
K <sub>v5</sub> (m <sup>3</sup> /h)		64	85	129	235
Weight (kg)		30	40	46	73
S (mm)	with ball valve	360	400	450	540
H (mm)		200	214	234	259
G (mm)		160	200	240	330
L (mm)		189	230	230	276
V (mm)		230	280	360	560
Weight (kg)		63	90	110	208
S (mm)	with butterfly valve	742	802	904	1132
H (mm)		205	219	239	290
V (mm)		206	206	206	285
Weight (kg)		51	69,4	87	155

Data given can be changed without notice.

Edition 01/2018

ZETKAMA Sp. z o.o.  
Ul. 3 Maja 12  
PL 57-410 Ścinawka Średnia

Tel. +48 74 8652 193  
Tel. +48 74 8652 111  
Fax +48 74 8652 199

E-mail spkraj@zetskama.com.pl  
www.zetskama.com

LOSS OF HEAD DIAGRAM

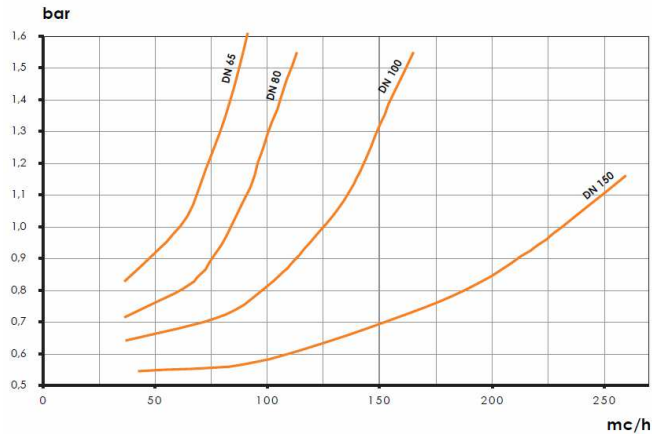

TYPE

Figure	Body material	Nominal diameter	Nominal pressure	Type
405	A Grey cast iron EN-GJL-250	65-150 mm	B 10 bar	disc with silicone rubber gasket 34

ORDERING

Figure	Body material	Nominal diameter	Nominal pressure	Type
405	A Grey cast iron EN-GJL-250	65-150 mm	B 10 bar	disc with silicone rubber gasket 34

Order example acc. index

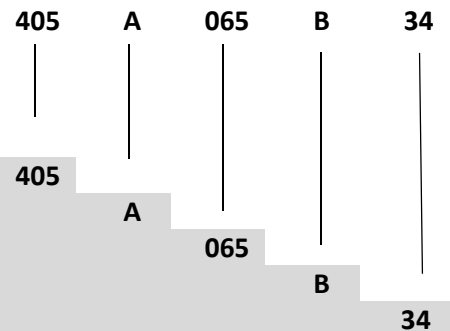

Backflow preventer, ends flanged, straight form  
 Grey cast iron EN-GJL-250  
 Nominal diameter (mm)  
 Nominal pressure PN 10  
 Disc with silicone rubber gasket

Data given can be changed without notice.

Edition 01/2018